

Senecaville

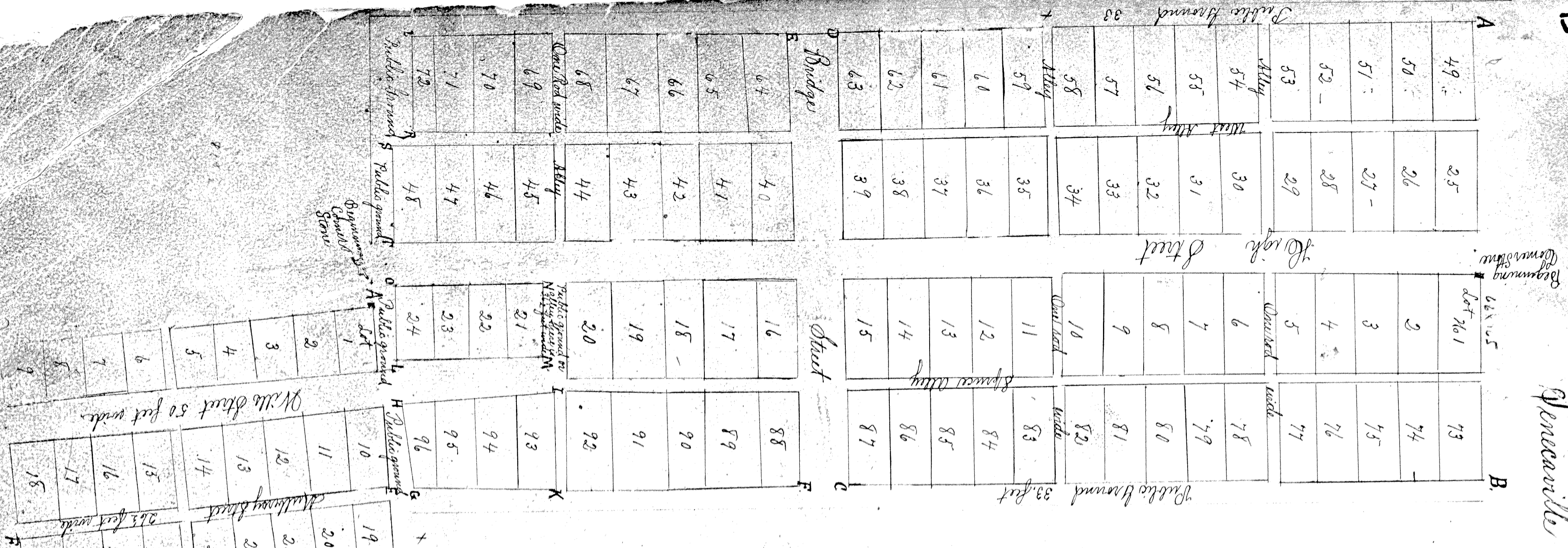

Thus before the Honorable William Keener, Circuit Judge, and Samuel Deane, William
 Shager and Stuart, Esqrs Examined, Variants, Judges of the Court of Common Pleas
 of the County of Hubbard and the State of Ohio, Court of David of the County of Seneca of said
 Court are the legal and true owners and possessors of the land hereinafter described and plat
 by the Matter of the Petition of Otto Habing and others to vacate
 the original plat of the town of Seneca and of the addition
 thereto and to allow the plat to stand from and to be established
 and to give as the plat of said town
 the one of October in the year of our Lord one thousand eight hundred and
 forty one, caused the Petitioner, by Joseph Degehardt Esquire, their Attorney and legal
 agent, to file of the Clerk of the Court of Common Pleas within and for the County
 of Hubbard and the State of Ohio the following petition to wit, Do the Honorable
 the Judges of the Court of Common Pleas of the County of Seneca, the Petition
 of the undersigned Citizens of the Town of Seneca, in said County of Hubbard, respectfully
 represent that an arrangement of a certain unincorporated town and certain part of
 said town has unconstitutionally and illegally been made and erected, in
 manner not to agree with said plat and for the purpose, according to the provisions
 as therein contained, to make an arrangement of said arrangement of an arrangement
 not entered into by said Citizens that said town should be annexed and included
 by the County thereof, which was an arrangement with said arrangement caused into
 effect (all of which said arrangement and plat are hereby attached) by the Petitioner
 (who are) Citizens and residents and owners of said town and
 portions of the same of the following name, do hereby most earnestly request
 that the Original plat of the said addition be vacated and that they
 plat made by the said County of Seneca for the purpose of said arrangement may be
 established as the plat of said town and that the boundaries which have been marked on the old plat not
 only now stand, 1841, 1842, 1843, 1844, 1845, 1846, 1847, 1848, 1849, 1850, 1851, 1852, 1853, 1854, 1855,
 to be vacated by this proceeding until
 Otto Habing, Benjamin Rodgers,
 John Degehardt, William Deane,
 (now called) Samuel Deane,
 W. S. Fortell, William Deane,
 William Degehardt, Samuel Deane,
 George Lee, John Deane,
 W. S. Deane, John Deane,
 Robert Johnson, Robert Johnson,
 J. S. Deane, Robert Johnson,
 they first appeared to on the foregoing petition
 and request attached as are the words
 and figures following to wit:

Each lot contains one fourth of an acre; except lot 10
 number 21, 22, 23, 24, which contain 29 3/4 square
 rods and 80 1/2 acres; 72 contain 29 square rods and 1/2
 acre; 96 contain 2 1/2 square rods and 1/2 acre; 110
 contain 96 square rods in the north side of the half lot 72
 and 73 feet wide south of lot 71, 48 to 40 feet wide south of lot 72
 24 to 16 at the west end 43 feet wide and at the east end 33
 feet wide and north of lot No 96 is 33 feet wide

Corner	Bearing	Distance
A to B	S 78° 45' E 45 rods & 2 1/2 links	
B to C	S 13° W 62 rods	
C to D	N 78° 30' E 74 rods & 2 1/2 links	
D to E	S 15° W 62 rods	
E to F	N 78° 30' E 74 rods & 2 1/2 links	
F to G	S 15° W 62 rods	
G to H	N 78° 30' E 74 rods & 2 1/2 links	
H to I	S 15° W 62 rods	
I to J	N 78° 30' E 74 rods & 2 1/2 links	
J to K	S 15° W 62 rods	
K to L	N 78° 30' E 74 rods & 2 1/2 links	
L to M	S 15° W 62 rods	
M to N	N 78° 30' E 74 rods & 2 1/2 links	
N to O	S 15° W 62 rods	
O to P	N 78° 30' E 74 rods & 2 1/2 links	
P to Q	S 15° W 62 rods	
Q to R	N 78° 30' E 74 rods & 2 1/2 links	
R to S	S 15° W 62 rods	
S to T	N 78° 30' E 74 rods & 2 1/2 links	
T to U	S 15° W 62 rods	
U to V	N 78° 30' E 74 rods & 2 1/2 links	
V to W	S 15° W 62 rods	
W to X	N 78° 30' E 74 rods & 2 1/2 links	
X to Y	S 15° W 62 rods	
Y to Z	N 78° 30' E 74 rods & 2 1/2 links	
Z to A	S 15° W 62 rods	

Seneca Creek

Each lot contains one fourth of an acre; except lot 10
 number 21, 22, 23, 24, which contain 29 3/4 square
 rods and 80 1/2 acres; 72 contain 29 square rods and 1/2
 acre; 96 contain 2 1/2 square rods and 1/2 acre; 110
 contain 96 square rods in the north side of the half lot 72
 and 73 feet wide south of lot 71, 48 to 40 feet wide south of lot 72
 24 to 16 at the west end 43 feet wide and at the east end 33
 feet wide and north of lot No 96 is 33 feet wide